

B.S. Swal

Principal
Subbaiah Institute of Dental Sciences
NH-13, H.H. Road, Purale
SHIVAMOGGA-577 222, Karnataka

GROUND FLOOR PLAN

SPECIFICATIONS:	1. FOUNDATION	U.G.R.M.R.C.C.
	2. ROOFING	CEMENT CONCRETE
3. WALLS	3.1. EXTERIOR	100mm thick
	3.2. INTERIOR	80mm thick
4. FLOORING	4.1. GENERAL	100mm concrete
	4.2. SPECIAL	As per design
5. PAINTING	5.1. EXTERIOR	As per design
	5.2. INTERIOR	As per design
6. DOORS	6.1. GENERAL	As per design
	6.2. SPECIAL	As per design
7. SANITARY FITTINGS	7.1. GENERAL	As per design
	7.2. SPECIAL	As per design
8. ELECTRICALS	8.1. GENERAL	As per design
	8.2. SPECIAL	As per design

PROPOSED SUBBAIAH DENTAL COLLEGE	TITLE:
PROPOSED SUBBAIAH DENTAL COLLEGE	FIRST FLOOR AREA : 45,919

PROPOSED SUBBAIAH DENTAL COLLEGE	SCALE: 1:100
PROPOSED SUBBAIAH DENTAL COLLEGE	SHEET NO: 2/4

PROPOSED SUBBAIAH DENTAL COLLEGE	OWNER: SUBBAIAH
PROPOSED SUBBAIAH DENTAL COLLEGE	DESIGNER: CIVIL FORUM

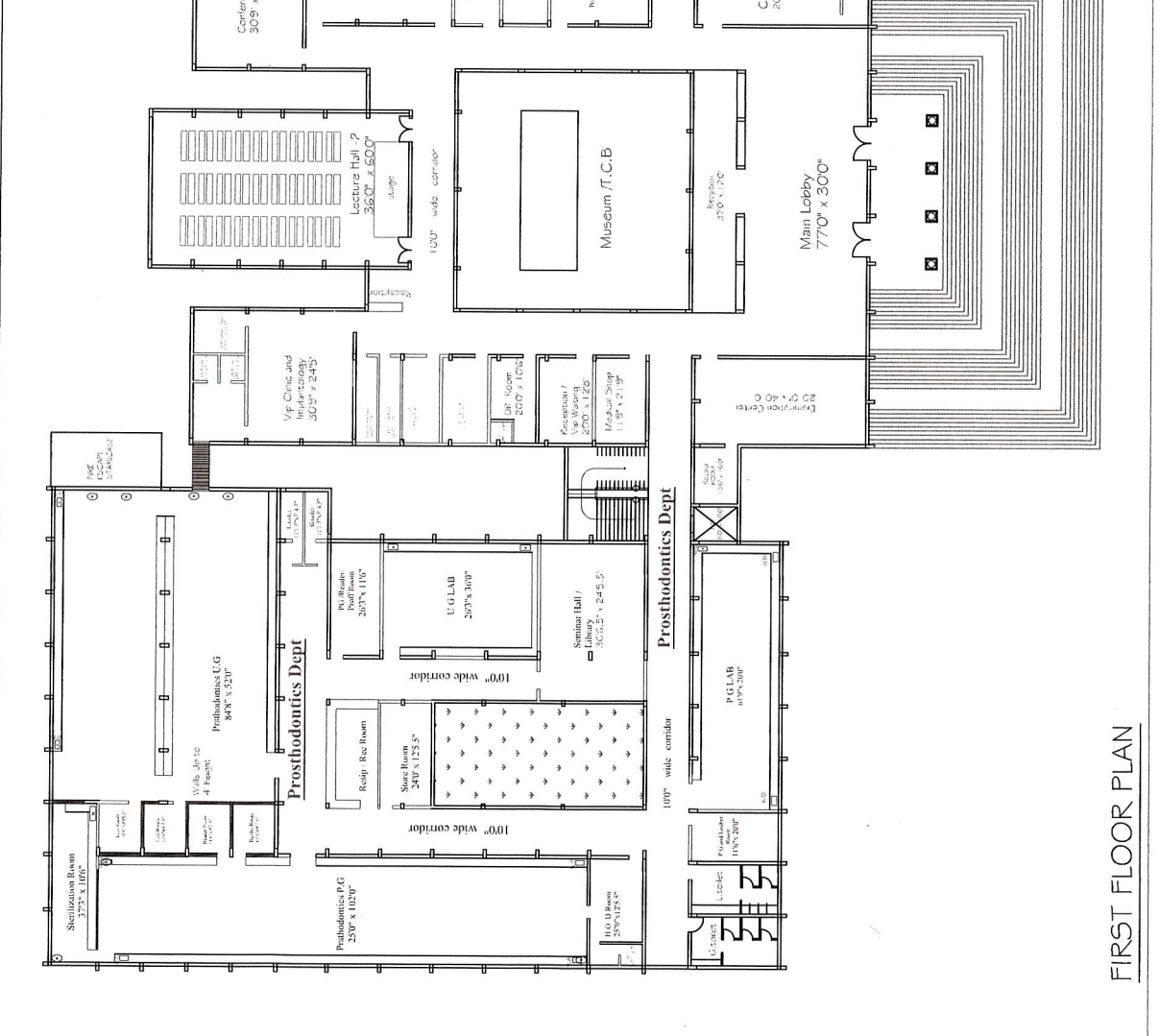

B.S.S.
Principal

Subbaiah Institute of Dental Sciences
NH-13, H.H. Road, Purale
SHIVAMOGGA-577 222, Karnataka

FIRST FLOOR PLAN



SPECIFICATIONS: 1. FOUNDATION: U.C.B. MORTAR 2. EXTERIOR: CRACK RESISTANT 3. INTERIOR: 12.5mm Gypsum Board, R.C.C. 1:2:4 4. SLOPE STRICK: ISI 5. FINISHING: BRICK, T.O.M. 6. FLOORING: POLISHED GRADE 7. DOOR/HANDLING: 12.5mm Gypsum Board 8. SANITARY/SUPPLIES: AS PER A.M.P. 9. ELECTRIFICATION: AS PER A.M.P.		REVISIONS: NO. DATE BY 1 10/10/2018 2 10/10/2018 3 10/10/2018 4 10/10/2018 5 10/10/2018 6 10/10/2018 7 10/10/2018 8 10/10/2018 9 10/10/2018 10 10/10/2018 11 10/10/2018 12 10/10/2018 13 10/10/2018 14 10/10/2018 15 10/10/2018 16 10/10/2018 17 10/10/2018 18 10/10/2018 19 10/10/2018 20 10/10/2018 21 10/10/2018 22 10/10/2018 23 10/10/2018 24 10/10/2018 25 10/10/2018 26 10/10/2018 27 10/10/2018 28 10/10/2018 29 10/10/2018 30 10/10/2018 31 10/10/2018 32 10/10/2018 33 10/10/2018 34 10/10/2018 35 10/10/2018 36 10/10/2018 37 10/10/2018 38 10/10/2018 39 10/10/2018 40 10/10/2018 41 10/10/2018 42 10/10/2018 43 10/10/2018 44 10/10/2018 45 10/10/2018 46 10/10/2018 47 10/10/2018 48 10/10/2018 49 10/10/2018 50 10/10/2018 51 10/10/2018 52 10/10/2018 53 10/10/2018 54 10/10/2018 55 10/10/2018 56 10/10/2018 57 10/10/2018 58 10/10/2018 59 10/10/2018 60 10/10/2018 61 10/10/2018 62 10/10/2018 63 10/10/2018 64 10/10/2018 65 10/10/2018 66 10/10/2018 67 10/10/2018 68 10/10/2018 69 10/10/2018 70 10/10/2018 71 10/10/2018 72 10/10/2018 73 10/10/2018 74 10/10/2018 75 10/10/2018 76 10/10/2018 77 10/10/2018 78 10/10/2018 79 10/10/2018 80 10/10/2018 81 10/10/2018 82 10/10/2018 83 10/10/2018 84 10/10/2018 85 10/10/2018 86 10/10/2018 87 10/10/2018 88 10/10/2018 89 10/10/2018 90 10/10/2018 91 10/10/2018 92 10/10/2018 93 10/10/2018 94 10/10/2018 95 10/10/2018 96 10/10/2018 97 10/10/2018 98 10/10/2018 99 10/10/2018 100 10/10/2018
NOTES: 1. ALL DIMENSIONS ARE IN METERS UNLESS OTHERWISE SPECIFIED. 2. ALL WALLS ARE 230mm THICK UNLESS OTHERWISE SPECIFIED. 3. ALL DOORS ARE 900mm WIDE UNLESS OTHERWISE SPECIFIED. 4. ALL WINDOWS ARE 1200mm WIDE UNLESS OTHERWISE SPECIFIED. 5. ALL FLOORS ARE FINISHED TO THE TOP OF THE SLAB UNLESS OTHERWISE SPECIFIED. 6. ALL ROOFS ARE FINISHED TO THE TOP OF THE SLAB UNLESS OTHERWISE SPECIFIED. 7. ALL STAIRS ARE FINISHED TO THE TOP OF THE SLAB UNLESS OTHERWISE SPECIFIED. 8. ALL ELEVATIONS ARE TO THE FINISHED SURFACE UNLESS OTHERWISE SPECIFIED. 9. ALL DIMENSIONS ARE TO THE CENTERLINE UNLESS OTHERWISE SPECIFIED. 10. ALL DIMENSIONS ARE TO THE FACE UNLESS OTHERWISE SPECIFIED. 11. ALL DIMENSIONS ARE TO THE CENTERLINE UNLESS OTHERWISE SPECIFIED. 12. ALL DIMENSIONS ARE TO THE FACE UNLESS OTHERWISE SPECIFIED. 13. ALL DIMENSIONS ARE TO THE CENTERLINE UNLESS OTHERWISE SPECIFIED. 14. ALL DIMENSIONS ARE TO THE FACE UNLESS OTHERWISE SPECIFIED. 15. ALL DIMENSIONS ARE TO THE CENTERLINE UNLESS OTHERWISE SPECIFIED. 16. ALL DIMENSIONS ARE TO THE FACE UNLESS OTHERWISE SPECIFIED. 17. ALL DIMENSIONS ARE TO THE CENTERLINE UNLESS OTHERWISE SPECIFIED. 18. ALL DIMENSIONS ARE TO THE FACE UNLESS OTHERWISE SPECIFIED. 19. ALL DIMENSIONS ARE TO THE CENTERLINE UNLESS OTHERWISE SPECIFIED. 20. ALL DIMENSIONS ARE TO THE FACE UNLESS OTHERWISE SPECIFIED. 21. ALL DIMENSIONS ARE TO THE CENTERLINE UNLESS OTHERWISE SPECIFIED. 22. ALL DIMENSIONS ARE TO THE FACE UNLESS OTHERWISE SPECIFIED. 23. ALL DIMENSIONS ARE TO THE CENTERLINE UNLESS OTHERWISE SPECIFIED. 24. ALL DIMENSIONS ARE TO THE FACE UNLESS OTHERWISE SPECIFIED. 25. ALL DIMENSIONS ARE TO THE CENTERLINE UNLESS OTHERWISE SPECIFIED. 26. ALL DIMENSIONS ARE TO THE FACE UNLESS OTHERWISE SPECIFIED. 27. ALL DIMENSIONS ARE TO THE CENTERLINE UNLESS OTHERWISE SPECIFIED. 28. ALL DIMENSIONS ARE TO THE FACE UNLESS OTHERWISE SPECIFIED. 29. ALL DIMENSIONS ARE TO THE CENTERLINE UNLESS OTHERWISE SPECIFIED. 30. ALL DIMENSIONS ARE TO THE FACE UNLESS OTHERWISE SPECIFIED. 31. ALL DIMENSIONS ARE TO THE CENTERLINE UNLESS OTHERWISE SPECIFIED. 32. ALL DIMENSIONS ARE TO THE FACE UNLESS OTHERWISE SPECIFIED. 33. ALL DIMENSIONS ARE TO THE CENTERLINE UNLESS OTHERWISE SPECIFIED. 34. ALL DIMENSIONS ARE TO THE FACE UNLESS OTHERWISE SPECIFIED. 35. ALL DIMENSIONS ARE TO THE CENTERLINE UNLESS OTHERWISE SPECIFIED. 36. ALL DIMENSIONS ARE TO THE FACE UNLESS OTHERWISE SPECIFIED. 37. ALL DIMENSIONS ARE TO THE CENTERLINE UNLESS OTHERWISE SPECIFIED. 38. ALL DIMENSIONS ARE TO THE FACE UNLESS OTHERWISE SPECIFIED. 39. ALL DIMENSIONS ARE TO THE CENTERLINE UNLESS OTHERWISE SPECIFIED. 40. ALL DIMENSIONS ARE TO THE FACE UNLESS OTHERWISE SPECIFIED. 41. ALL DIMENSIONS ARE TO THE CENTERLINE UNLESS OTHERWISE SPECIFIED. 42. ALL DIMENSIONS ARE TO THE FACE UNLESS OTHERWISE SPECIFIED. 43. ALL DIMENSIONS ARE TO THE CENTERLINE UNLESS OTHERWISE SPECIFIED. 44. ALL DIMENSIONS ARE TO THE FACE UNLESS OTHERWISE SPECIFIED. 45. ALL DIMENSIONS ARE TO THE CENTERLINE UNLESS OTHERWISE SPECIFIED. 46. ALL DIMENSIONS ARE TO THE FACE UNLESS OTHERWISE SPECIFIED. 47. ALL DIMENSIONS ARE TO THE CENTERLINE UNLESS OTHERWISE SPECIFIED. 48. ALL DIMENSIONS ARE TO THE FACE UNLESS OTHERWISE SPECIFIED. 49. ALL DIMENSIONS ARE TO THE CENTERLINE UNLESS OTHERWISE SPECIFIED. 50. ALL DIMENSIONS ARE TO THE FACE UNLESS OTHERWISE SPECIFIED. 51. ALL DIMENSIONS ARE TO THE CENTERLINE UNLESS OTHERWISE SPECIFIED. 52. ALL DIMENSIONS ARE TO THE FACE UNLESS OTHERWISE SPECIFIED. 53. ALL DIMENSIONS ARE TO THE CENTERLINE UNLESS OTHERWISE SPECIFIED. 54. ALL DIMENSIONS ARE TO THE FACE UNLESS OTHERWISE SPECIFIED. 55. ALL DIMENSIONS ARE TO THE CENTERLINE UNLESS OTHERWISE SPECIFIED. 56. ALL DIMENSIONS ARE TO THE FACE UNLESS OTHERWISE SPECIFIED. 57. ALL DIMENSIONS ARE TO THE CENTERLINE UNLESS OTHERWISE SPECIFIED. 58. ALL DIMENSIONS ARE TO THE FACE UNLESS OTHERWISE SPECIFIED. 59. ALL DIMENSIONS ARE TO THE CENTERLINE UNLESS OTHERWISE SPECIFIED. 60. ALL DIMENSIONS ARE TO THE FACE UNLESS OTHERWISE SPECIFIED. 61. ALL DIMENSIONS ARE TO THE CENTERLINE UNLESS OTHERWISE SPECIFIED. 62. ALL DIMENSIONS ARE TO THE FACE UNLESS OTHERWISE SPECIFIED. 63. ALL DIMENSIONS ARE TO THE CENTERLINE UNLESS OTHERWISE SPECIFIED. 64. ALL DIMENSIONS ARE TO THE FACE UNLESS OTHERWISE SPECIFIED. 65. ALL DIMENSIONS ARE TO THE CENTERLINE UNLESS OTHERWISE SPECIFIED. 66. ALL DIMENSIONS ARE TO THE FACE UNLESS OTHERWISE SPECIFIED. 67. ALL DIMENSIONS ARE TO THE CENTERLINE UNLESS OTHERWISE SPECIFIED. 68. ALL DIMENSIONS ARE TO THE FACE UNLESS OTHERWISE SPECIFIED. 69. ALL DIMENSIONS ARE TO THE CENTERLINE UNLESS OTHERWISE SPECIFIED. 70. ALL DIMENSIONS ARE TO THE FACE UNLESS OTHERWISE SPECIFIED. 71. ALL DIMENSIONS ARE TO THE CENTERLINE UNLESS OTHERWISE SPECIFIED. 72. ALL DIMENSIONS ARE TO THE FACE UNLESS OTHERWISE SPECIFIED. 73. ALL DIMENSIONS ARE TO THE CENTERLINE UNLESS OTHERWISE SPECIFIED. 74. ALL DIMENSIONS ARE TO THE FACE UNLESS OTHERWISE SPECIFIED. 75. ALL DIMENSIONS ARE TO THE CENTERLINE UNLESS OTHERWISE SPECIFIED. 76. ALL DIMENSIONS ARE TO THE FACE UNLESS OTHERWISE SPECIFIED. 77. ALL DIMENSIONS ARE TO THE CENTERLINE UNLESS OTHERWISE SPECIFIED. 78. ALL DIMENSIONS ARE TO THE FACE UNLESS OTHERWISE SPECIFIED. 79. ALL DIMENSIONS ARE TO THE CENTERLINE UNLESS OTHERWISE SPECIFIED. 80. ALL DIMENSIONS ARE TO THE FACE UNLESS OTHERWISE SPECIFIED. 81. ALL DIMENSIONS ARE TO THE CENTERLINE UNLESS OTHERWISE SPECIFIED. 82. ALL DIMENSIONS ARE TO THE FACE UNLESS OTHERWISE SPECIFIED. 83. ALL DIMENSIONS ARE TO THE CENTERLINE UNLESS OTHERWISE SPECIFIED. 84. ALL DIMENSIONS ARE TO THE FACE UNLESS OTHERWISE SPECIFIED. 85. ALL DIMENSIONS ARE TO THE CENTERLINE UNLESS OTHERWISE SPECIFIED. 86. ALL DIMENSIONS ARE TO THE FACE UNLESS OTHERWISE SPECIFIED. 87. ALL DIMENSIONS ARE TO THE CENTERLINE UNLESS OTHERWISE SPECIFIED. 88. ALL DIMENSIONS ARE TO THE FACE UNLESS OTHERWISE SPECIFIED. 89. ALL DIMENSIONS ARE TO THE CENTERLINE UNLESS OTHERWISE SPECIFIED. 90. ALL DIMENSIONS ARE TO THE FACE UNLESS OTHERWISE SPECIFIED. 91. ALL DIMENSIONS ARE TO THE CENTERLINE UNLESS OTHERWISE SPECIFIED. 92. ALL DIMENSIONS ARE TO THE FACE UNLESS OTHERWISE SPECIFIED. 93. ALL DIMENSIONS ARE TO THE CENTERLINE UNLESS OTHERWISE SPECIFIED. 94. ALL DIMENSIONS ARE TO THE FACE UNLESS OTHERWISE SPECIFIED. 95. ALL DIMENSIONS ARE TO THE CENTERLINE UNLESS OTHERWISE SPECIFIED. 96. ALL DIMENSIONS ARE TO THE FACE UNLESS OTHERWISE SPECIFIED. 97. ALL DIMENSIONS ARE TO THE CENTERLINE UNLESS OTHERWISE SPECIFIED. 98. ALL DIMENSIONS ARE TO THE FACE UNLESS OTHERWISE SPECIFIED. 99. ALL DIMENSIONS ARE TO THE CENTERLINE UNLESS OTHERWISE SPECIFIED. 100. ALL DIMENSIONS ARE TO THE FACE UNLESS OTHERWISE SPECIFIED.		
SCALE: 1:100 ARCHITECT: SHRI. S. S. SIVANANDA ENGINEER: SHRI. S. S. SIVANANDA SHEET NO.: 4/14 DIVISION: ARCHITECTURE		

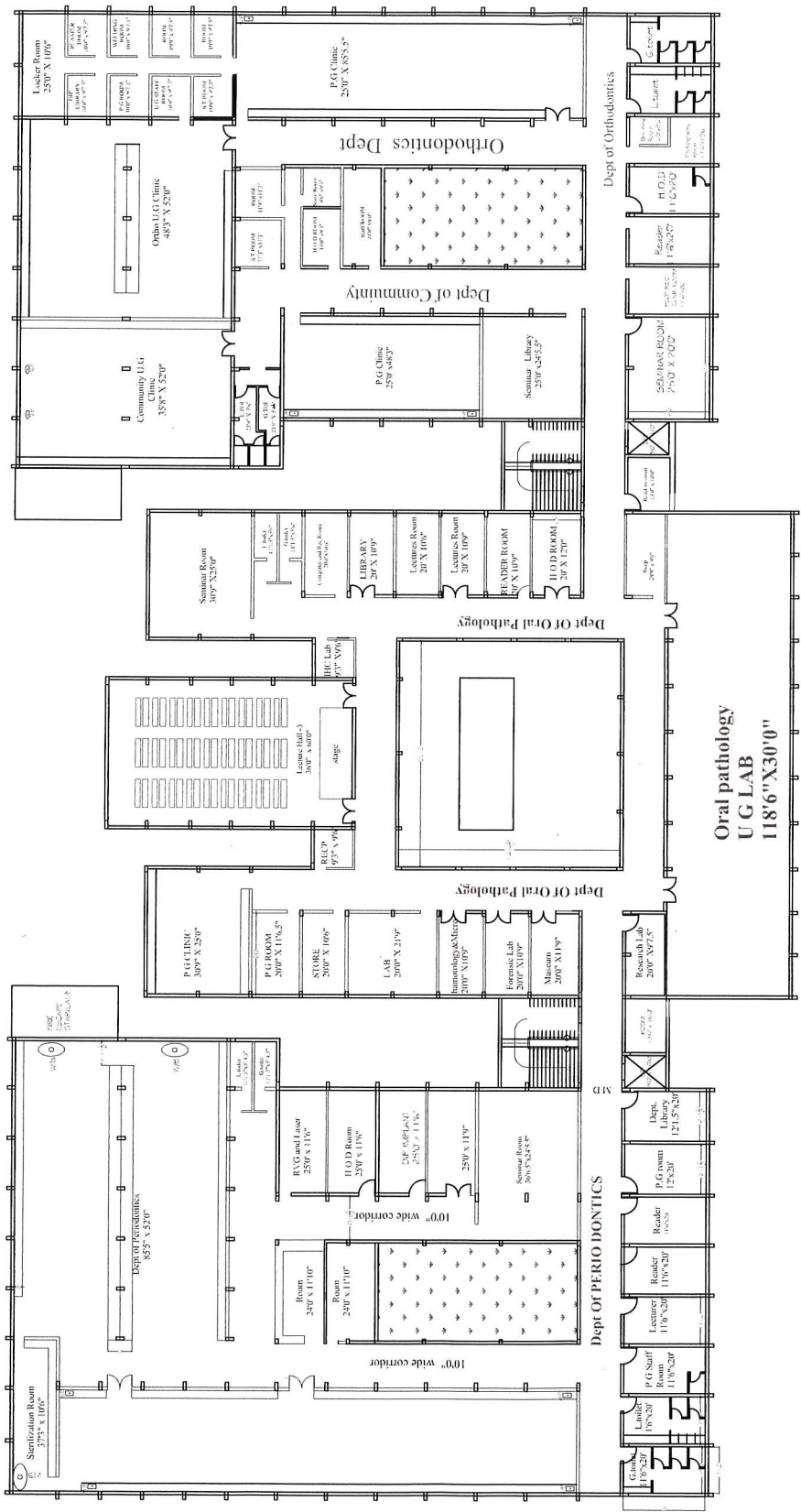

B. S. Sivil
Principal

Subbaiah Institute of Dental Sciences
 NH-13, H.H. Road, Purale
 SHIVAMOGGA-577 222, Karnataka

THIRD FLOOR PLAN





GOVERNMENT OF KARNATAKA, REVENUE DEPARTMENT.
 ಜಿಲ್ಲಾಧಿಕಾರಿಗಳ ಕಾರ್ಯಾಲಯ, ಶಿವಮೊಗ್ಗ ಜಿಲ್ಲೆ, ಶಿವಮೊಗ್ಗ.
 OFFICE OF THE DEPUTY COMMISSIONER, SHIMOGA DISTRICT, SHIMOGA.

ದೂರವಾಣಿ/PHONE: - 08182-271101/221010/222082; ಫ್ಯಾಕ್ಸ್/FAX: - 277082; ಇ-ಮೇಲ್/E-MAIL: - dcc.shimoga@gmail.com

NO. ALN(1).CR-005/14-15 (222/14-15)

Date:21-4-2014

TO WHOM SO EVER IT MAY CONCERN

This is to certify that the Lands mentioned in the below table are alienated to non agricultural (Dental college establishment) purpose . As per records available in this office, the said lands are not reserved for any public purpose till date.

Sl No.	Village	Sy.No.	Extent A-G	Khatadar Name	Alination Order No & date
1	Purale	108/2	1-07	Managing Trustee, Tedlkela SUBbaiahTrust, Near Subbaiah Complex, Jail Road, Shlmoga	ALN SR 169/08-09 Date : 19-02-2009
2	Purale	108/3	2-01		
3	Purale	109/3	2-00	Managing Trustee, Tedlkela SUBbaiahTrust, Near Subbaiah Complex, jail Road, Shlmoga	ALN SR 126/09-10 Date : 24-12-2009

To,

Managing Trustee,
 Tedlkela SUBbaiahTrust,
 Near Subbaiah Complex, Jail Road,
 Shlmoga

Additional Deputy Commissioner,
 Shimoga District
 SHIMOGA

B.S. Sural
Principal
Subbaiah Institute of Dental Sciences
 NH-13, H.H. Road, Purale
 SHIVAMOGGA-577 222, Karnataka

B.S. Sural
Principal
 Subbaiah Institute of Dental Sciences
 NH-13, H.H. Road, Purale
 SHIVAMOGGA-577 222, Karnataka

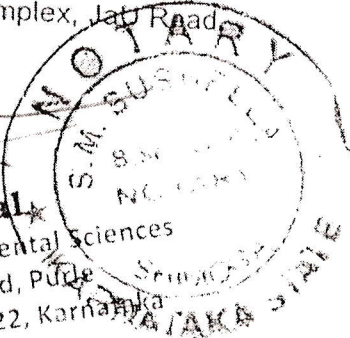

*certified map
 above Trustee
 has been made to
 Sural*

S.M. SUSHEELA
 22/04/14
 ZONAL PLANS.

ICT Enabled class Rooms



ICT enabled Class Rooms -1



ICT Enabled Class Room-2



ICT Enabled Class Room-3

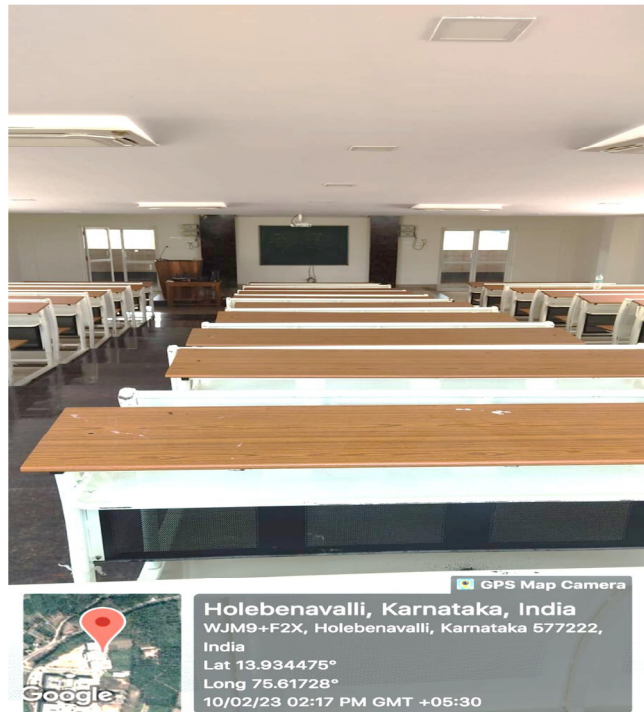

ICT Enabled Class Room-4

ICT Enabled Seminar Rooms

ICT enabled seminar room 1



ICT enabled seminar room 2



B.S. Kund
Principal

Subbaiah Institute of Dental Sciences
NH-13, H.H. Road, Purle
SHIVAMOGGA-577 222, Karnataka

ICT ENABLED SEMINAR ROOM-3



ICT ENABLED SEMINAR ROOM-4



B.S. Kund
Principal

Subbaiah Institute of Dental Sciences
NH-13, H.H. Road, Purle
SHIVAMOGGA-577 222, Karnataka

ICT ENABLED SEMINAR ROOM-5

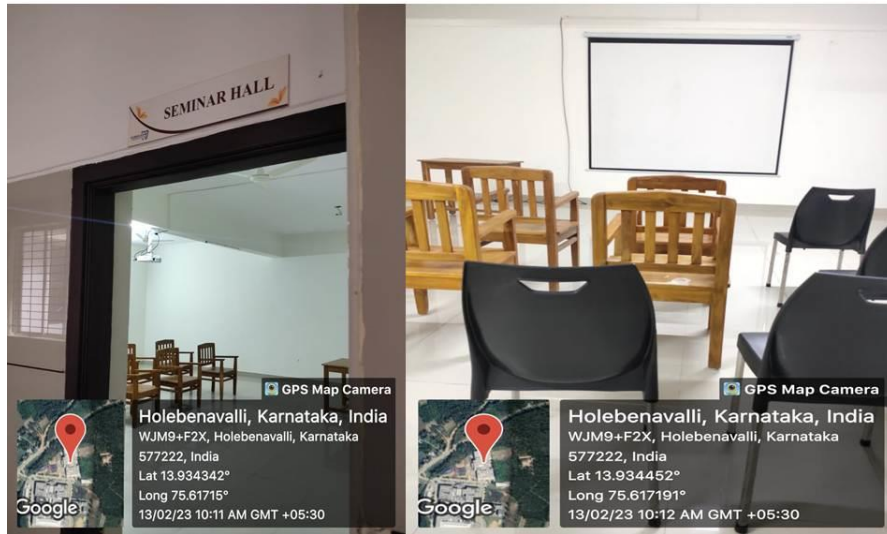

ICT ENABLED SEMINAR ROOM-6



B.S. Sankar
Principal

Subbaiah Institute of Dental Sciences
 NH-13, H.H. Road, Purle
 SHIVAMOGGA-577 222, Karnataka

ICT ENABLED SEMINAR ROOM-7



ICT ENABLED SEMINAR ROOM- 8

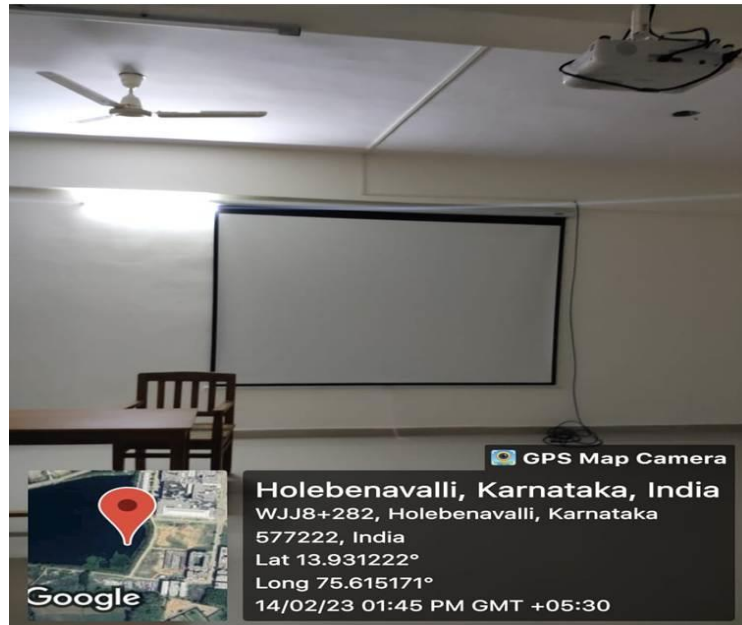

B.S. Suresh
Principal

Subbaiah Institute of Dental Sciences
NH-13, H.H. Road, Purle
SHIVAMOGGA-577 222, Karnataka

Facility for clinical learning

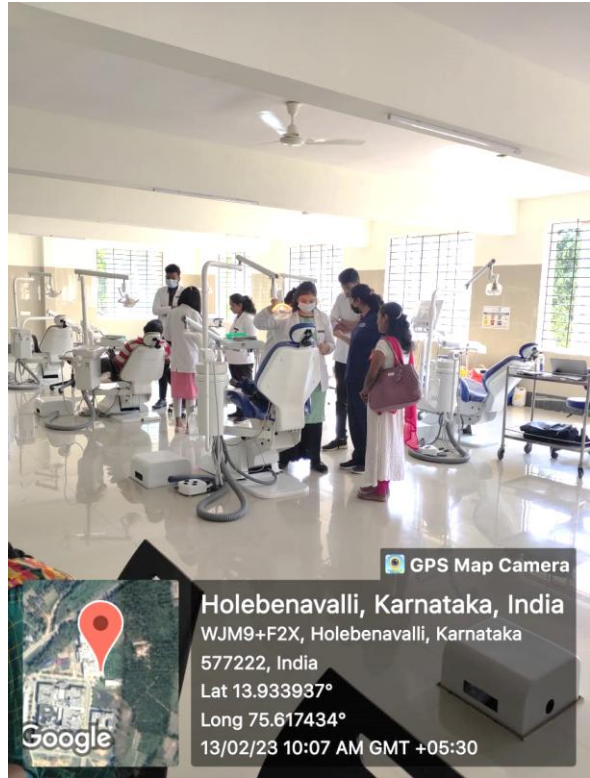

1. ORAL MEDICINE AND RADIOLOGY DEPARTMENT

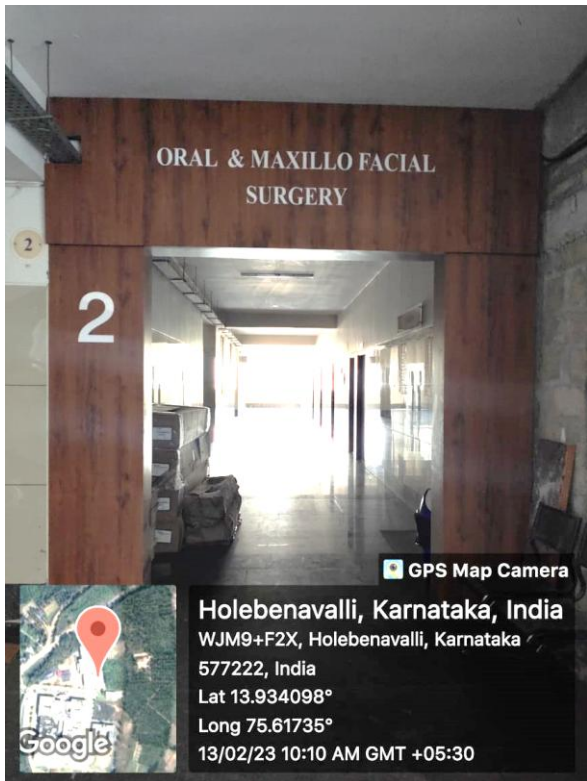

2. ORAL AND MAXILLOFACIAL SURGERY DEPARTMENT

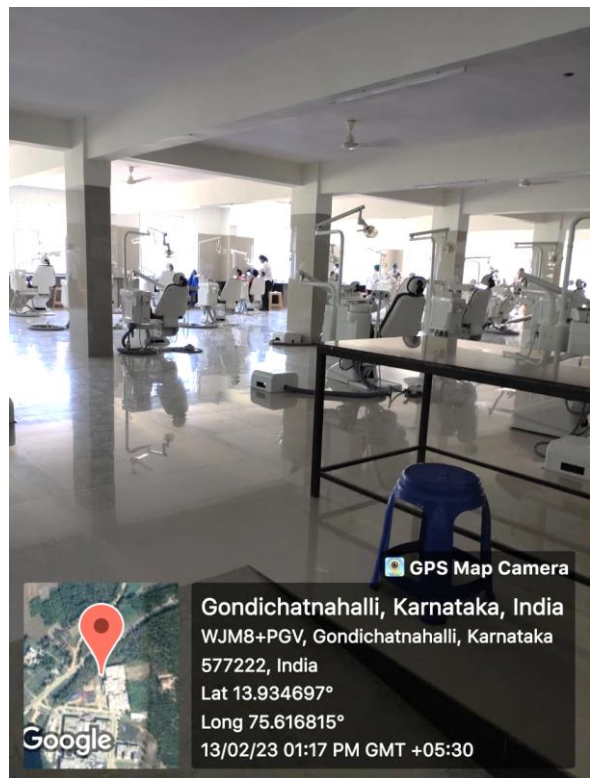
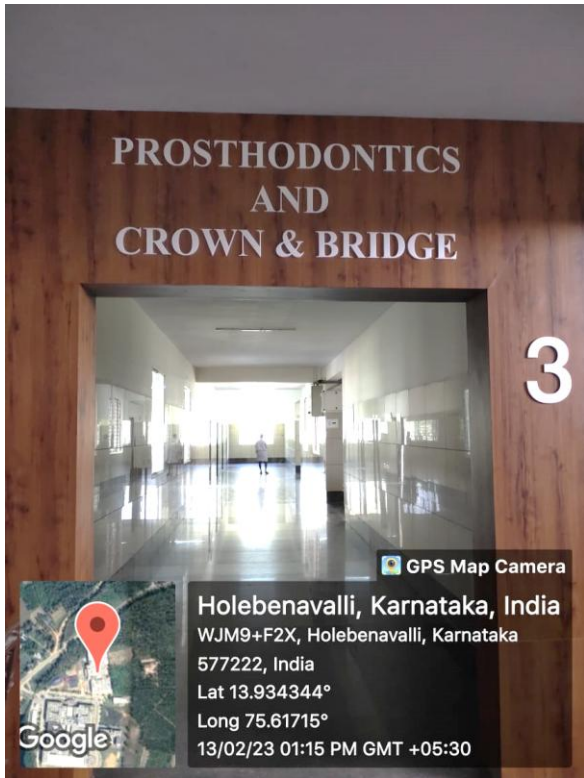

3. PROSTHODONTICS CROWN AND BRIDGE DEPARTMENT



B.S. [Signature]
Principal
 Subbaiah Institute of Dental Sciences
 NH-13, H.H. Road, Purlé
 SHIVAMOGGA-577 222, Karnataka

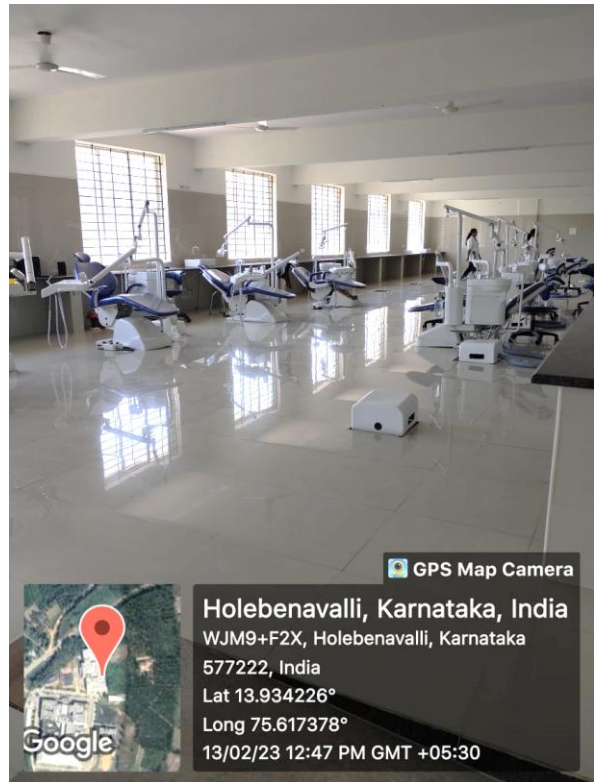

5. PEDIATRIC AND PREVENTIVE DENTISTRY DEPARTMENT

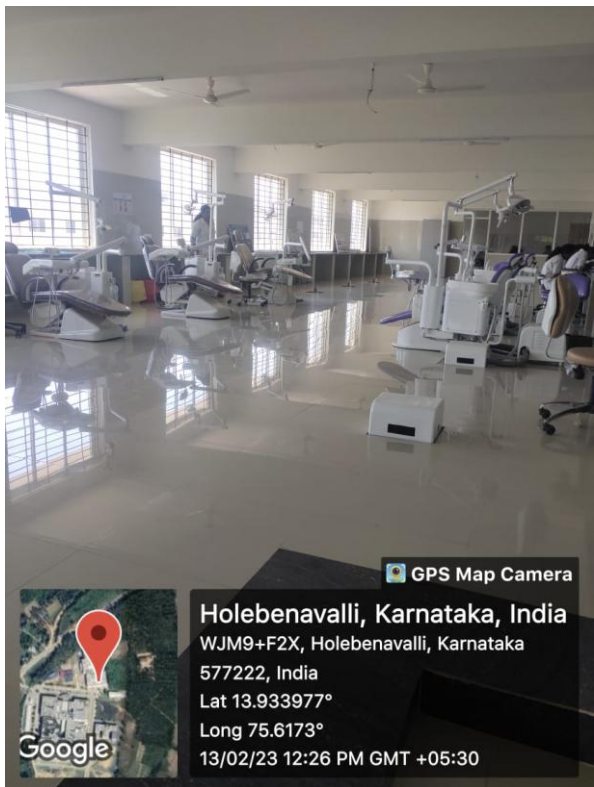
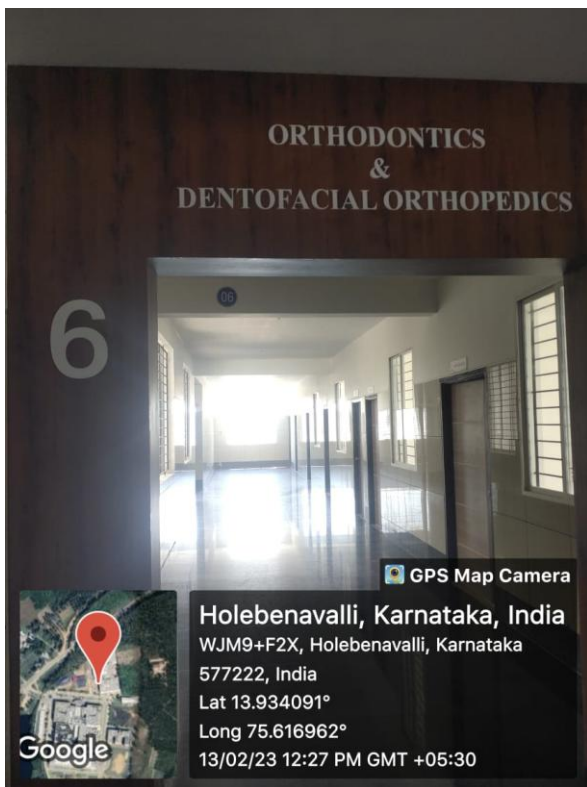

6. ORTHODONTICS AND DENTOFACIAL ORTHOPEDICS DEPARTMENT

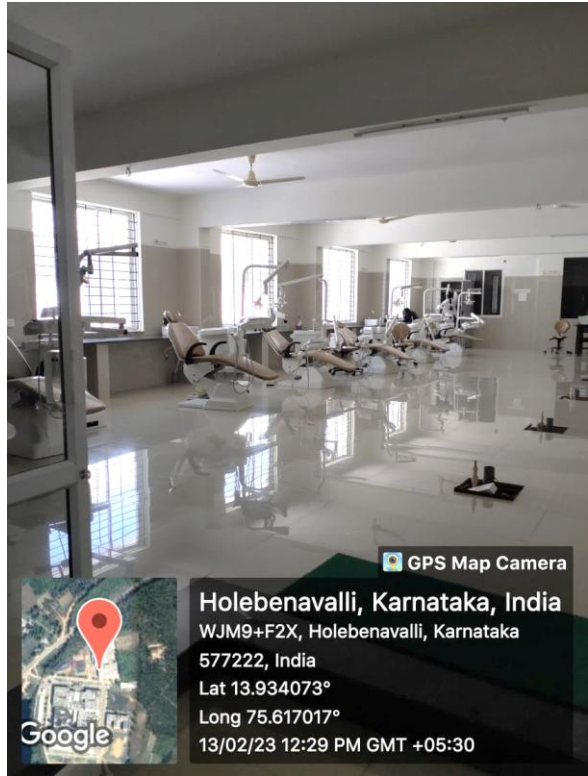

7. PUBLIC HEALTH DENTISTRY DEPARTMENT

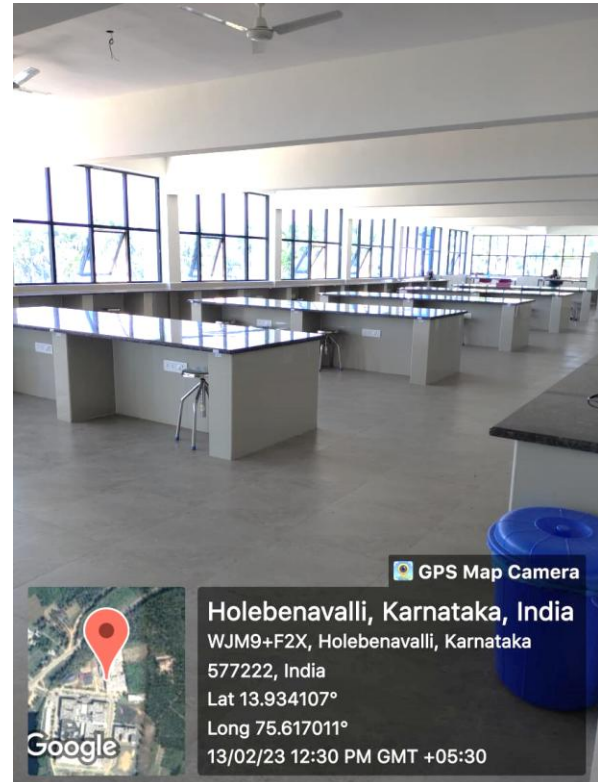

8. ORAL AND MAXILLOFACIAL PATHOLOGY DEPARTMENT

B.S. Kund
Principal

Subbaiah Institute of Dental Sciences
NH-13, H.H. Road, Purle
SHIVAMOGGA-577 222, Karnataka

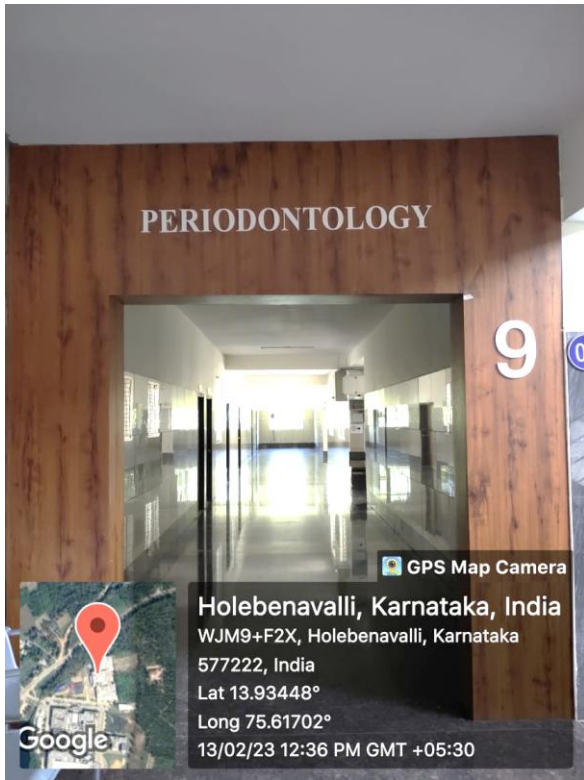

9. PERIODONTICS DEPARTMENT

B.S. Suresh
Principal

Subbaiah Institute of Dental Sciences
 NH-13, H.H. Road, Purle
 SHIVAMOGGA-577 222, Karnataka

Attached medical teaching hospital



Principal
Subbaiah Institute of Dental Sciences
10N-13, H.K. Road, Purle
SHIVAMOGGA-577 232, Karnataka

Facility for community based learning

Mobile Dental Van



B.S. Suresh

Principal

Subbaiah Institute of Dental Sciences
NH-13, H.H. Road, Purle
SHIVAMOGGA-577 222, Karnataka

TWO DENTAL CHAIRS INSIDE THE MOBILE DENTAL VAN



SEATING FACILITY INSIDIE THE MOBILE DENTAL VAN

Satelite dental centers

1:Mydolalu



B.S. Sunk
Principal

Subbaiah Institute of Dental Sciences
NH-13, H.H. Road, Purle
SHIVAMOGGA-577 222, Karnataka

2:Kommnalu



B.S. Sankar
Principal

Subbaiah Institute of Dental Sciences
NH-13, H.H. Road, Purle
SHIVAMOGGA-577 222, Karnataka

Tobacco cessation clinic



B.S. Suresh
Principal

Subbaiah Institute of Dental Sciences
NH-13, H.H. Road, Purle
SHIVAMOGGA-577 222, Karnataka

Laboratories

Physiology lab



B.S. Kund
Principal
Subbaiah Institute of Dental Sciences
NH-13, H.H. Road, Purle
SHIVAMOGGA-577 222, Karnataka

Phantom head simulation lab

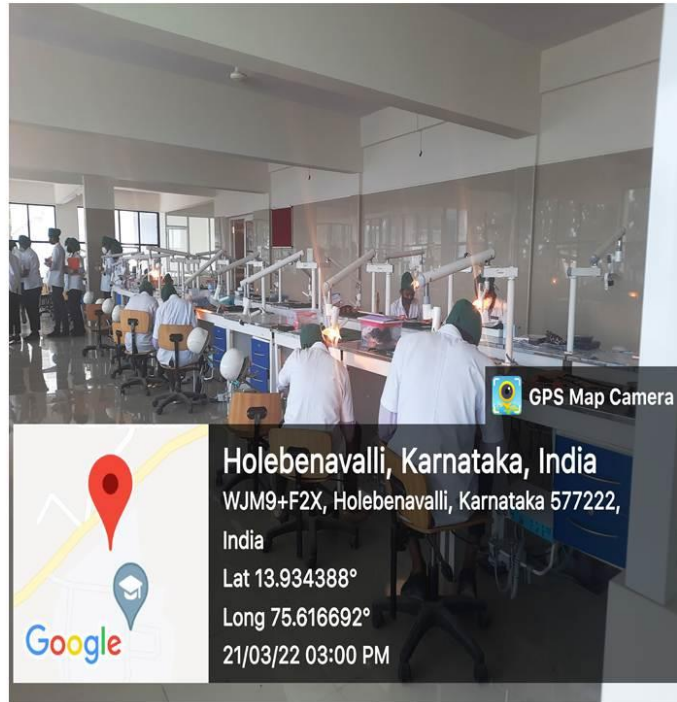
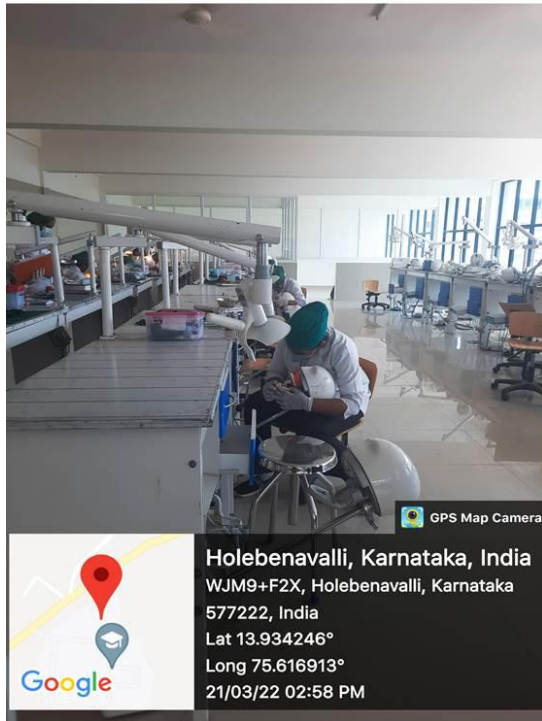

B.S. Kundu
Principal

Subbaiah Institute of Dental Sciences
NH-13, H.H. Road, Purle
SHIVAMOGGA-577 222, Karnataka

Pathology lab

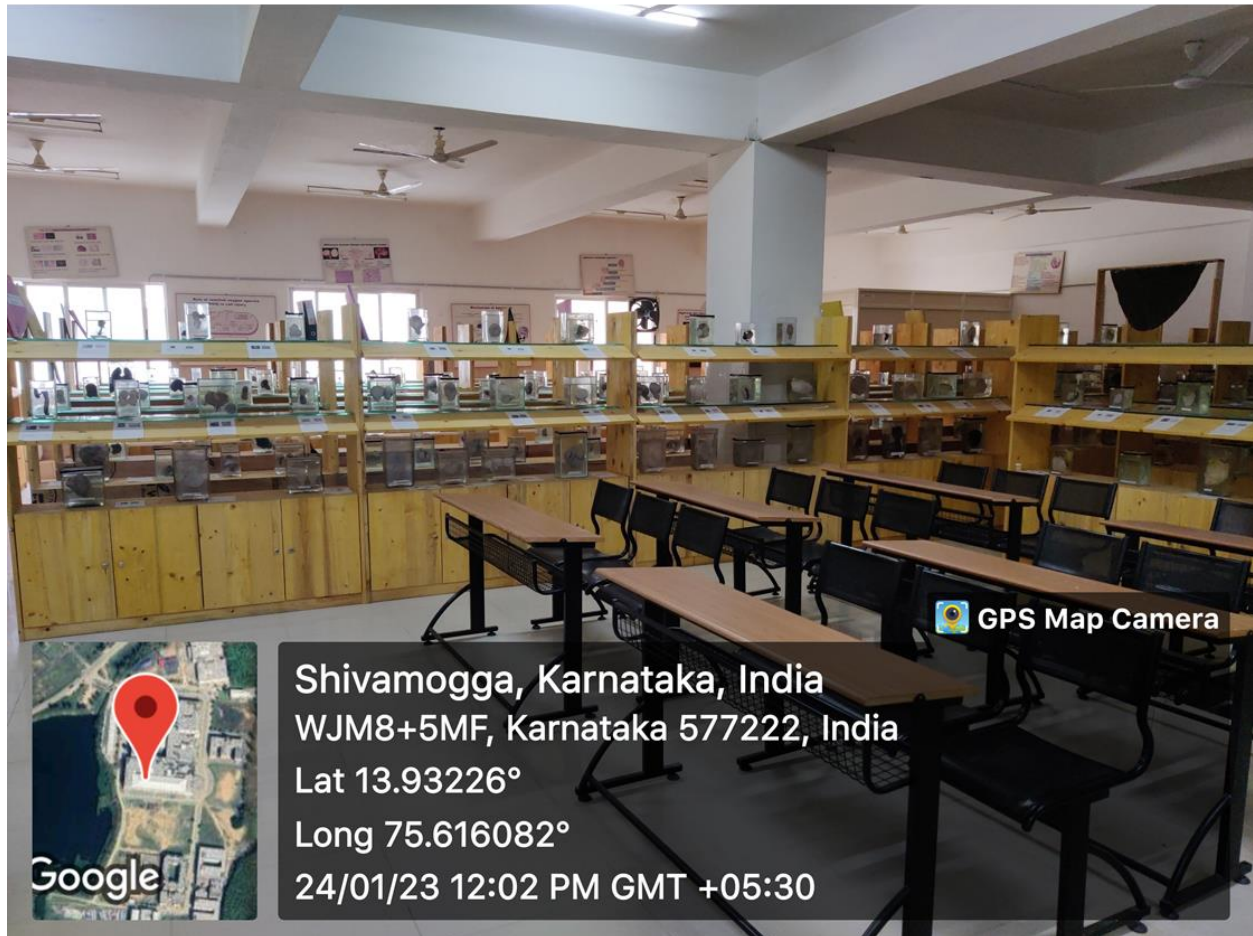

B.S. Sankar

Principal

Subbaiah Institute of Dental Sciences

NH-13, H.H. Road, Purle

SHIVAMOGGA-577 222, Karnataka

Anatomy lab



Shivamogga, Karnataka, India
WJM8+5MF, Karnataka 577222, India
Lat 13.93238°
Long 75.616082°
24/01/23 11:53 AM GMT +05:30

Biochemistry lab



 GPS Map Camera

Shivamogga, Karnataka, India

WJJ8+VP, Shivamogga, Karnataka

577222, India

Lat 13.932229°

Long 75.616784°

15/02/23 11:00 AM GMT +05:30

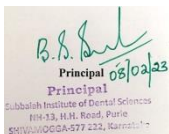

Pharmacology lab



B.S. Kund
Principal

Subbaiah Institute of Dental Sciences
NH-13, H.H. Road, Purle
SHIVAMOGGA-577 222, Karnataka

Microbiology lab



B.S. Suresh
Principal

Subbaiah Institute of Dental Sciences
NH-13, H.H. Road, Purle
SHIVAMOGGA-577 222, Karnataka

Skill lab



B.S. Kund
Principal

Subbaiah Institute of Dental Sciences
NH-13, H.H. Road, Purle
SHIVAMOGGA-577 222, Karnataka

CERAMIC LABORATORY

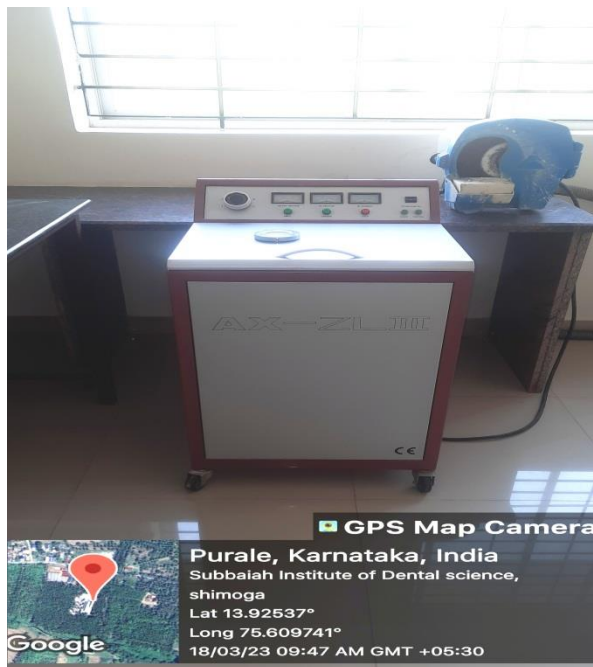

B.S. Sankar
Principal
Subbaiah Institute of Dental Sciences
NH-13, H.H. Road, Purle
SHIMMOGGA-577 222, Karnataka

PRE CLINICAL PROSTHODONTIC LAB



DENTAL MATERIALS LAB

B.S. Kulkarni
Principal
Subbaiah Institute of Dental Sciences
111-13, H.H. Road, Purla
SHIVAMOGGA-577 222, Karnataka

DENTAL ANATOMY LAB



B.S. Sankar
Principal

Subbaiah Institute of Dental Sciences
NH-13, H.H. Road, Purle
SHIVAMOGGA-577 222, Karnataka